



Our Community Met the Challenge

Sahuarita 
FoodBank

& Community Resource Center

2020 Community Report

The Impact of Covid—Hear Our Voices

Executive Director Carlos Valles

It is hard to believe that six months ago we completely changed our mode of distribution to a drive-through model. I knew it was going to be difficult on our volunteers and clients. No longer would our volunteers and clients have friendly chats. Handshakes and hugs would cease. Instead, we exchange warm smiles behind windshields and waves from the curbside. We might have changed 99% of our distribution model but the commitment to our clients has never been stronger.

Without the National Guard helping every week, we could not have served twice as many hungry community members. When I separated from the military years ago, I never imagined that I would work alongside our service members sharing the same mission again. Our volunteers have embraced the National Guard as part of the SFB-CRC family. The National Guard's eagerness to help out where needed and their amiability have won the hearts of both clients and volunteers.

I am not just lucky. I am truly blessed to work on a team with so many individuals who want to make a positive impact on our community even during a pandemic. Without them, there are no streamlined operations. Without them, we are not able to provide nutritious foods. Without them, you get the hint! They are my heroes who make it all possible!



Food Bank Client Maria



I came to the Sahuarita Food Bank four and five years ago, then stopped coming because my family did not need the assistance. However, a couple months ago, my husband who was working in landscaping had a very serious accident. After surgery and hospitalization, he still needs six to twelve months to be able to return to work. After he lost his job, our family—including three grandchildren who live with us—did not have enough to eat. I started making and selling burritos and tamales on the street near a park.

Sometimes I buy small items that I can resell at a markup. I also work with my husband on his physical therapy, because we cannot afford to get it elsewhere. I don't want anything for free, but the Sahuarita Food Bank has been extremely helpful to us in this very difficult time. I can open the fridge and see there is food for my family. The food we receive frees up money for my diabetes medicine, soap and cleaning supplies.

My grandmother taught me to be strong, and I have to keep my strength for my husband.

I can't cry. Although I am sad, I feel that I have a guardian angel.

Project Manager Roni Singh

One word to describe my impression of the food bank would be “adaptable.” The world has seemed to have taken a turn and interrupted what we know as the norm. One would think that this could bring the food bank to a halt or into chaos, but it had the opposite effect. Challenges created by the Covid pandemic brought out our critical thinking skills, and we all came up with solutions on how to make a safe environment for our volunteers and clients. We experienced glitches and hiccups, but our team has worked hard to solve those problems.



Sue and Roni

I am continuously impressed by how we grow together as a family. I see volunteers helping one another and the people within the community. I can think of four volunteers who go the extra mile by dropping food off to neighbors in need. And the clients who receive that extra care express appreciation for their selflessness. Other clients also frequently give positive feedback such as “Thank you for the work you are doing,” “Que Dios te bendiga,” and “You have done an amazing job at making this easy for us.” I’m excited to be a part of this team and blessed to stand together with you for this mission.

Volunteer Leader Sue Eaton

We have had to accept Covid-19 and have been able to meet the needs of our increased client base. Although many of our volunteers are older and at high risk, a small core of our volunteers has been completely reliable. Getting to know and work with the National Guard has been such a positive experience during this time. We also purchased and use the new remote intercom system to protect our clients and volunteers and provide efficient and personalized service. I miss not being able to see or interact with our clients in the same way, and it has been very hard not to work with or see so many of our dedicated volunteers. We’ve had to cancel all of our early childhood programs, including Storytime at the SFB, but thanks to Friends of the Library we are able to bag new books to distribute to our families when they come to pick-up their food.

Board President Penny Pestle



You have heard the voices of a food bank client, our executive director, and volunteer leaders. They have spoken about great challenges, but also resilience and commitment to service.

When so many organizations shut down, a very small team of volunteers and staff dedicated themselves to providing our essential services. And our donors immediately provided funding to assist those affected by Covid. Without this support, we would have closed our doors.

By the end of next year, our new building will be complete. With our incredible team—our valued volunteers, Carlos and a lean staff, marvelous board and community partners—we will be fully prepared to make measurable progress on our goals of “Food and Economic Security for All!”

A New Facility to Serve Our Community

We're Out of Space

The pandemic has only made it clearer that we need more space to meet the needs of our neighbors. Because the need is urgent, we are moving ahead with building, trusting that those who share our mission will help us the rest of the way.

Help Complete the Capital Campaign

In the last year we've made great progress on the *Nourishing Our Community* capital campaign. With the support of many generous donors and community partners, we have raised more than \$2,000,000, 70% of our current goal. We need your help to complete this community facility.

Increased Capacity and New Programs

Our new building will expand our capacity to deliver food, family support, and workforce development programs. For example, when space and health guidelines allow, we're ready to go with Caregiver and Nurse Assistant certification classes in partnership with Pima Community College. We're also getting ready to offer women's food entrepreneurship classes. And we are incubating more such programs to help our neighbors thrive. To learn more about this exciting project please contact Curt Keim at ckeim@sfb-crc.org.

Take A Tour

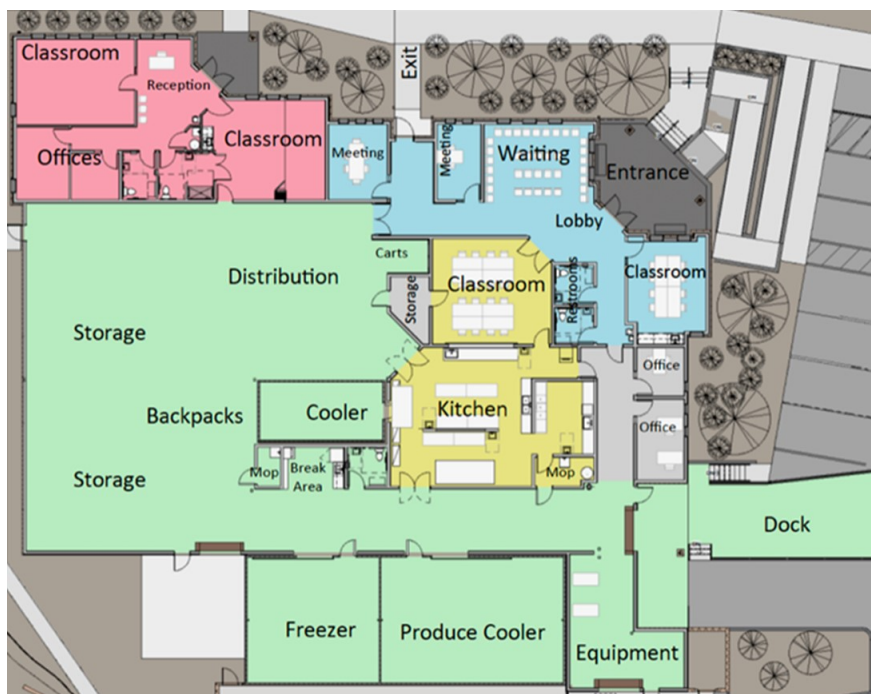

Food Bank The green area is primarily for the food bank. It includes a large food distribution area with a reach-in-cooler, dry-storage pallet racks, a Back-Pack assembly area, a volunteer break nook, a large walk-in freezer and refrigerator, and a loading dock.

Reception The blue area serves as reception for the food bank, with rooms for registration and meeting, waiting, children's reading, and restrooms. This area also can double as CRC space when the food bank is not open, with offices for visiting agencies and two classrooms.

Kitchen and Kitchen Classroom Codes require a commercial kitchen, in yellow, when we clean and sort produce for food bank distribution. But the kitchen and the next-door classroom with a window into the kitchen will serve so much more. We can use them, for example, to teach nutrition and cooking, incubate food businesses,

Community Resource Center Wing The red area is devoted to the CRC. One classroom can accommodate Pima Community College classes for training health care workers, but it can also serve other CRC uses. In the second classroom we'll teach all sorts of skills and there will be ample educational technology. The two offices can be used for a CRC director and/or visiting agencies that offer client services.

Administration and Parking We saved space, indicated in light gray, for staff and volunteer offices. There will be 18 parking spaces in front of the building and another 18 across the wash to the south.



These Donors Contributed to the Capital Campaign through August 2020

Please let us know if we inadvertently misspelled or omitted your name.

Curt and Nancy Ackley
Amphenol
Arthur and Jan Anderson
Anonymous
Jim Armstrong and
Rebecca McElfresh
Joan Athey
Sally Ayers
Doodee Backstrom
David and Anita Bailey
Daniel and Karen Barr
Steve and Marian Bell
Connie Bennett
Dennis and Sara Beyer
Bill's Home Service Company
Judy Bischoff
Duane and Margaret Blumberg
Brenda Bowers
Ralph and Jane Bristol
Murney Brown
Jeff Bruce
Buddhist Global Relief Fund
Robert Buehler
Barbara Buesing
Walt Burzycki and Susan Eaton
Henry and Sara Busey
Community Food Bank of
Southern Arizona
Russ and Blyth Carpenter
Jon David Carter
Donald and Rosalie Cassidy
Paul and Gail Chaffee
Katherine Clancy
Mary Clark
Clyde and Darlene Clement
Bill and Ann Cochran
Francis Collins
Phil and Connie Conklin
Core Construction
Hathaway Cornelius and
Nancy Bowen
Jeffrey Counter
David and Deborah Cowan
Ellen Cox
Bob and Elizabeth Crosett
Rex Crouse and Dale Jones
Michael and Jana Cullberg
John Dale
Susan Davis
Robert and Kathy Davisson
Anthony Day
Michael Day
Cynthia Dean
Andrew DeCraene and Billy Kidd
Richard and Dolores Degan

Desert Hills Lutheran Church
David and Anna Dethmers
Arthur Dixon and Jane Lateer
William and Diane Diamond
Dick and Pam Duchaine
Mary Eakle
Kenneth and Elizabeth Eden
Tom and Jackie Edwards
Peter and Phyllis Eichman
Marcella Erler
Rick and Joan Ernst
James Ertel
Burt Eubank
Joseph Grabiell and Sherri Cadeaux
Excel Home Inspections
Earl and Barb Eyre
James and Joyce Fearnside
Michael and Joyce Finkelstein
David and Nancy Flatt
Kenneth and Sheila Frahm
Freeport-McMoRan Foundation
Ed Freedman
Jim and Christie Furber
Arturo and Rosanna Gabaldon
Linda Gates
Fred and Francie Ginocchio
Dick and Andi Ginsburg
Al and Jan Gleason
John and Dolores Gleb
Carolyn Goodrich
Robert and Ruth Goodrich
Mary Greer
Green Valley Rotary Foundation
Green Valley Recreation Foundation
Mary Grgich
David and Jane Grodin
Phyllis Hallman
Donn and Ruthanna Higley
Rich and Susan Hill
Richard and Lynda Himbury
Ann Hirz
Judy Holcomb
Marjorie Holmstrom
Mark and Susan Horton
Carolyn Hubbard
Orion and Monte Hudson
Nancy Hungate
Gary and Lisa Israel
Darrell and Betty Johnson
Pres Johnson
Christian and Diana Joos
Robert and Virginia Juettner
Curt and Karen Keim
Marian Kellermeyer
Kay Kennard

Kelvin and Becky Kent
Linda Kopley
David and Marilyn Kern
Bill and Marge Kinkad
John and Patricia Kozma
KMW Communications
Janet Krueger
La Canoa Lions Club
La Posada Foundation
Lois Leichsenring
Jack and Nancy Lindeman
Thomas Lindmeier
Lineage Logistics
Terry and Nancy Linthicum
Stephen and Irene Little
Parker and Martha Long
Melinda Louise and Linda Jehle
James Love and Susan Colby
Roger and Sharon Ludlam
Bob and Mary Mareck
Drew and Jan Mason
Jack and Kathy Mattox
James and Barbara Mauser
Dick and Flo Mayer
Randy and Norma Mayer
William McNarie
Anne Mendenhall
Christina Menendez
Dan and Diane Meyer
Talmadge and Judy Middleton
Stephen and Mary Miller
Bruce and Judy Moulton
Bette Mulley
Thomas and Lynn Murphy
Gayla Murray
Teena Murray
June Newton
Jim and Kay Novak
Berdell Nelson
Shannon O'Connor
William and Jill Pawlowski
Dave Perry
James and Joy Perry
John and Penny Pestle
Ron and Gerry Peterson
Pima County
Michael and Rozie Plotnik
Quail Creek Lady Putters
Quail Creek Men's 9 Hole Golf
Assoc. (Desert Duffers)
Henne Queisser
Hal and Marita Ramsey
Tom and Marilyn Regnier
Gary and Jill Reid
Noel Reinhillier

Carl and Cynthia Roberts
Sandra Rooney
Rosemont Copper Mine-
Hudbay Minerals, Inc.
Roger Rushlow and
Peggy Hendrickson
Don and Marjorie Saiser
Carrie Scheufler
James and Diane Scovil
Mathew Scully
Don and Jan Segraves
Kristine Sells
Richard and Suellen Shaw
Shield Bar Marketing
Lynn Shinnick
David and Linda Sielken
Dick and Maggie Sievers
Harry and Joyce Smith
Steve and Jackie Smith
Stuart and Bev Smith
Southwest Energy
Doug Spear
Dennis and Carol St. John
Jay and June St. John
Laurence and Jan Stevens
Michael Stewart
Rosemary Stoltenberg
Ann Striker and Valerie Diamond
Sundt Foundation
Douglas and Linda Syme
Tsukiyo Tanaka
Gordon and Margaret Tans
Steve Teichner
Wayne and Bette Teter
Judy Thoreson
Anne Towne
Marilyn Townley
Manuel Valenzuela
Rowland and Judy Van Es
Alex and Alison Vaughn
David and Carol Vleck
James Ward
Michael and Lara Warren
W.F. Stevens Financial Advisors
Gretchen Weir
Larry and Sandra Wheeler
Thomas and Mary Wilsted
Judith Whipple
Elaine Wood
Larry Worster and Leslie DeGrassi
David Wright
Betsy Zoolkoski

Your Impact on Our Daily Operations

In 2019-2020 generous donors like you allowed SFB-CRC to supply enough food for 900,000 meals in all our programs including the Thursday/Saturday main distribution, BackPacks for 450 kids in 8 schools, Wednesday produce distribution, the Commodity Senior Food Program, and two pantries in very low-income communities.

Sahuarita Food Bank



Food helps people like “Sandra,” who told us that she had breast cancer and was starting radiation and chemo. During the pandemic, she has counted on the food she gets from us to feed her extended family including her new grandchild. “Andrea” and “David” came because they had no food in their cupboards or fridge and are no longer able to work. With your help we supply food twice a month and they signed up for CSFP, a supplemental food program for very low-income persons over 60.

Community Resource Center

Family Support: Until the pandemic hit in March, your support allowed SFB-CRC and partners to offer a number of family support programs including screening new clients for benefit eligibility, child literacy, tax preparation, and parenting classes.

Workforce Development: Our goal is to add programs that help neighbors find jobs or better jobs. When CDC guidelines permit, we’ll partner with Pima Community College to offer classes to train Certified Caregivers and Certified Nurse Assistants. Meanwhile, we’re developing an entrepreneurship course to help low-income women start food businesses.

New Programs: With your financial support, we are able to hire a bilingual part-time consultant to survey our community to discover ways the resource center can expand in the new facility.

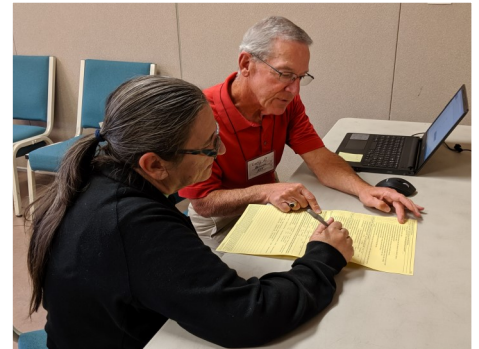

SFB-CRC leadership assists in convening the Better Together Southern Arizona Coalition, which creates collaborative and long-term solutions to improve the economic self-sufficiency of all members of our community. This coalition includes local school districts, governments, faith communities, human services agencies, businesses, and community residents.

Budget Overview 2020-2021

Revenue

Individual Contributions	\$126,500
Grants and Contracts	\$210,000
Better Together Grants	\$25,000
2019-2020 Carryover	\$37,720
Total Revenue	\$399,220

Expenditures

Food Bank & Community Resource Center	
Emergency Food Purchases	\$ 31,100
BackPacks (food for children)	\$64,000
Covid-19 Expenses	\$53,800
Community Resource Center Programs	\$10,000
Operations (e.g., office, utilities, insurance, lease, audit, vehicles maintenance)	\$74,320
Fundraising	\$5,000
Personnel	\$118,700
Better Together	\$27,300
Reserve Funds	\$15,000
Total Expenditures	\$399,220

Value of In-kind Food Donation	\$1,700,000
% of budget for administration	3.8%

Thank You!



Clients thank us in many ways!

Thank you to our major organizational donors to operations.



Join 878 Donors Who Contributed to Operations 2019 - August 2020

Please let us know if we
inadvertently misspelled
or omitted your name.

Andrew and Sally Abbott	C. L. Borum	Gloria Contreras	Roger and Janice Ederle
Curt and Nancy Ackley	Brenda Bowers	Raymond Cook	David and Alison Edgerton
Linda Adams	Michael Bowers	James and Nancy Coon	Sue Edgerton
Darcy Adshead	John Boyd	Martha Copeland	Brian and Jean Edwards
John and Connie Aglione	Ann Bradford	David and Marilyn Cordovano	Harold Edwards
Mary Ahlbrecht	Parker Bray	Mark Corley	John and Marilyn Ehrhardt
Victoria Alcorta	Neil and Shill Breedyk	Hathaway Cornelius and	Peter and Phyllis Eichman
Diane Allen	Del and Marge Brewer	Nancy Bowen	Richard and Sharon English
Ken Allen	Teresa Brine	John Corrigan, Sr.	Marvin and Sharon Erdelt
Arthur and Jan Anderson	Ralph and Jane Bristol	Tressa Coss	Barbara Erickson
Carolyn Anderson	Laurence Brock and Marilyn Kidd	Joan Countryman	James Ertel
Daniel Anderson	Donna Brown	David and Deborah Cowan	Manny Espino
Karen Andreasen	Murney Brown	Ellen Cox	John and Julie Essame
David Andrew	Patricia Bruner	Todd and Rebecca Craig	Ramon and Michelle Estavillo
Diane Andrews	Samuel Bruno	Jerry and Patricia Crane	Burt Eubank
Joanne Anthony	Mary Jo Bruskiewicz	Bob and Betty Crossett	Ronald Evans
Thea Arai	Robert Buehler	Carol Crothers	Margaret Everett
Meredith Archer	David and Beverly Buerstetta	Rex Crouse and Dale Jones	Roscoe and Linda Ewalt
Jim Anderson and	Barbara Buesing	Allen Cuddy	Robert and Laura Fahlberg
Rebecca McElfresh	Tom Buinicky and Mary Ferland	Steve and Sally Culler	James and Joyce Fearnside
Roberta Atkins	Susan Burch	Terry and Lana Curl	Barbara Fecht
Suzanne Attanasio	John Burke	Sarah Dachtly	John and Joyce Feese
James and Margaret Avent	Tom and Jane Burns	Polly Daly	Dennis and Leslie Fellner
John Aydent	Timothy and Anita Burton	Richard and Terry Daly	Cynthia Fiehler
Kathryn Babcock	Ricard and Cheryl Burton	John Damon	Kruse Fillerup
David and Karen Bachman	Walter Burzycki and Susan Eaton	Michael Dant	Dee Fink
Doodee Backstrom	Henry and Sara Busey	Jessica Davenport	Michael and Joyce Finkelstein
Susan Baker	Vern and Wanda Butler	Cathy Davis	Thomas and Mary Fischer
Colleen Baldwin	Colleen Byers	Jenifer Davis	David and Nancy Flatt
Amelia Baliling	Gary Cain	Susan Davis	Kurtis Fluck and Pam Farris
Alyson Ball	Kimberly Cajas	Vallie (Beth) Davis	Alicia Fogal
James and Augusta Ballowe	Wayne Carlson	Robert and Kathleen Davisson	Dennis and Janice Foster
Richard and Elizabeth Balsbaugh	Elaine Carlton	Michael Day	Kathleen Fragola
Jeanne Baly	Claudia Carmichael	Cynthia Dean	Ken and Sheila Frahm
Paul and Linda Barclay	Timothy and Lynn Carpenter	Richard and Diana Deaver	Gail Frank
Ricardo and Jane Barnes	Gerald and Patricia Carrell	Andrew DeCreane and Billy Kidd	Martha Fray
Daniel and Karen Barr	Gary and Lucille Carroll	Jeff and Anita Degen	Ed Freedman
Jonathan and Carolyn Bass	Jim and Janet Carter	Richard and Dolores Degen	Dusty and Lenny Friedman
Mark and Gillian Batterman	Jon David Carter	Gordon Denham and	Gary Friedman
Cornelia Bayley	Norman and Elaine Carver	Michele Fedderly	Virginia Friend
G. G. Becker	Kathleen Casey	Debra Denison	Patricia Frontzak
Ruth Becker	Donald and Rosalie Cassiday	David and Anna Dethmers	Ed and Sumi Fulwider
S. A. Beery-Walker	Ralph and Margaret Castillo	James DeWilde	Jim and Christie Furber
E. J. Behnkie	Yolanda Castillo	William and Diane Diamond	Joseph Gabriel and Sherri Cadeaux
Brigitte Belknap	Eric Cedarquist and	James and Ann Diberardinis	Lyman Gage
J. Stephen and Marion Bell	Sharon O'Connor	Sally Dick	Barry and Mary Ganapol
Lenore Bell	Paul and Gail Chaffee	Michael and Barbara Didonato	Richard and Saville Gardner
Connie Bennett	Dean and Carolyn Chaussee	Victor and Judith Diloeto	Brigitte Garfield
Rita Benoit	Lincoln and Sydney Chayes	Richard and Diane Diou	Gail Garrison
Bruce Benso	Mary Chernowski	Arthur Dixon and Jane Lateer	Linda Gasser and Roberta Timmons
James Berg	Thomas and Louise Cherry	Carol Dixon	Shelby Geddes
Richard and Marilyn Bernard	R. Chris Chesterfield-Gould	Barbara Doerrer-Peacock	Mimi Gendreau
Lois Berry	Herbert and Corinne Chilstrom	Porfirio Dominguez	Janet Gerdes
Dennis and Sara Beyer	Richard and Vicki Chvala	Thomas and Rhonda Donohue	Doris Gerganoff
John and Dolores Bieb	Barbara Clagett	Bruce and Marcia Downing	Betty Gibson
Michael and Pamela Biller	Betty Clapp	Dick and Pam Duchaine	Kathy Gilchrist
Clarice Bird	Helen Clarkson	Richard Ducote	Mary Gilliam
John and Barbara Bird	Clyde and Darlene Clement	Christopher Dudding	Fred and Francine Gilmore
Richard Birdsall	Bill and Ann Cochran	Thomas and Lila Duff	Charles and Mary Glover
Judy Bischoff	Elizabeth Cohen	F. Timothy Dugan	Larry Goetz
Barry and Marianne Bishop	Carol Cole	Richard Duncan	Carol Goldberg
Jerry and Sharon Bisping	Lisa Cole	Donald Dunn	Carolyn Goodrich
Loren Black	Vicki Coleman	Eugene and Lola Dunsirn	Robert Goodrich
Wayne and Carol Blake	Francis Collins	Paul Durante	Robert Goold
Rita Blakeslee	Gary and Jerilyn Collins	Sandra Duty	Lloyd and Catherine Gould
Celia Blank	Jeffrey Collins	Rita Dwelley	Michele Goza
Elizabeth Blasdel	Jim Collins	Sam and Sage Dyer	Carol Grandfield
Ashley Blood	Stephen and Betsy Conklin	Mary Eakle	John Grant
David and Brenda Bloomer	Mary Connell	Carrell Ebert	Mary Graves
Colandra Bonaparte	Arthur and Karen Conner	Kenneth and Elizabeth Eden	Charles Grayson

Donors to Operations July 2019 - August 2020, continued

Kent and Marilou Green	Germaine Jenkins	Dan Lilly	Patricia Morrill
Thomas and Valerie Green	Michael and Jacqueline Jensen	Thomas Lindmeier	Douglas and June Moses
James Greer	Clodio Jimenez and Claudia Sedano	Victor and Judith Linn	Kana Mott
Mary Greer	Eric Jiran	Terry and Nancy Linthicum	Melora Mott
Fred and Mary Grgich	Daniel and Cynthia Johnson	Ronald and Helen Loflin	Louise Moultrie
Laurel Grindy	Mark Johnson	Mark and Debra Logan	Gerald Mowris
Jack and Deb Grobe	Reynold and Mary Johnson	Vince Lombardi	Bette Mulley
David and Jane Grondin	Robert and Josephina Johnson	James and June Lombardo	Patrick and Judith Mulligan
Margaret Grost	Veronica Johnson	Shirley Looney	Erwin and Karen Mund
Thomas and Suzanne Guier	Jo Ann Jones	Larry and Mary Lorenz	John Munger
David Guiliet and Mary Dondelinger	Marcia Jones	Claude and Christiane Louedec	Howard and Donna Murphy
Scott Gulas	Mary Jones	Rebecca Lowe	Kenneth and Kimberly Murphy
Kathryn Gullen	Suzanne Jones	Brent Lucas	James Mylar and Joanna Corrigan
Carol Gunneman	William and Janice Jones	Gary and Mary Lungstrum	Raymond and Martha Nachreiner
Judith Gunson	Christian and Diana Joos	Frances Lunney	Chris and Lora Nastase
William and Barbara Gurwitz-Hall	Laurie Jurs and Jennifer Clarke	Robert and Ruth Lyngholm	James and Patricia Neel
Louis and Luann Guthmueller	Thomas and Catheryn Kane	Arland and Sharon Lyons	Brenda Nelson
James and Mary Guy	Paul and Petra Karnatz	Ebrahim Maarouf	Fredrick and Mary Newton
Jerrold and Donna Haas	Bill and Stacy Kehrwald	Jeanne Macauley	June Newton
Marilyn Habicht	Curt and Karen Keim	Jane Machina	Martha Nicolas
Patricia Hall	Marian Kellermeyer	Ian and Linda MacLeod	Alice Nielsen
Phyllis Hallman	J. L. and Roberta Kelly	Marjorie Macneill	Edwin Nieves-Beauchamp and
Donna Harrison	Geoffrey and Jean Kemp	John MacNutt and Thyra Strapac	Cherelyn Clark
David and Patricia Hartwell	Kay Kennard	Susan Magno	Gail Norton
Marvin Hass	Sharon Kennedy	Lon Main	Jim and Kay Novak
Lewis Hawkins	Shianne Kennedy	Edward and Alyce Mancini	Fred and Paula Nowotny
Paul and Rhoda Hayes	Kelvin and Becky Kent	Dorthea Mancke	Kay Nyswonger
Judith Haynes	Suzy Kent	Ronald and Nancy Mang	Sharon O'Connor
Raymond Hazelbaker	David and Marilyn Kern	Paul Marano	Richard and Jolene Oja
Ray and Nancy Hebert	Maralyn Keyes	Robert and Mary Mareck	Judith Olsen
Roger and Sonia Heeren	Karen Kilmer	Rick and Lynette Marksberry	Harvey and Mary Olson
Joan Heinz	Bill and Marge Kinkad	James and Linda Martin	Marilyn Olson
Donald and Gail Helland	Roger and Dee Kleckner	Kerry Martin	Ray and Starr Omdahl
Yoshie Hennessy	Cynthia Kloss	Mary Martin	Roger and Treasure Omdahl
Carlos Henriquez and	Eugene and Dena Knox	Louis and Elizabeth Martin	Ilene O'Neal
Mary Chapman	Eugina Knuth	Pam Martin	Kevin Opalka
Greg and Carrie Herren	Stefanie Koeller	Stephanie Martin	Joan Orjada
William Herrington	Myrna Kolodge	Carlos and Virginia Martinez	Bruce and Ann Ostern
Chad Hick	Janet Kozick	Drew and Jan Mason	John and Charlene Ostlund
Richard and Susan Hill	John and Patricia Kozma	George and Gloria Mathes	Beverly Otte
Richard and Lynda Himbury	Marilyn Kressin	Dick and Flo Mayer	James and Lynn Oxenford
Diane Hinds	Jack and Karen Kressley	Megan McAllister	Barbara Oxner
Byron Hinton, Jr.	Marianne Kretschmer	Stephen and Gail McCarthy	Susan Palfrey
Ann Hirz	Paul and Linda Krienitz	Alan and Jan McClellan	DK Palmer
Mollie Hoben	Janet Krueger	William and Claudia McCormack	Ted and Jan Panhuis
Carol Hocking	Paula Kuhlina	William and Nancy McCormick	Larry and Bonnie Papenfuss
James Hoff	Debra Kushner	Kathleen McCormick	Ronald and Vivian Parle
Jeff and Rebecca Hogge	Jennifer Kuzawa	Douglas and Susan McCune	Michael Patterson
Madison Hogge	George and Cheryl Kvenvold	James and Nancy McDaniel	Mark and Jacalyn Paulsel
Judy Holcomb	Linda Kyle	George and Peggy McGaughy	William and Jill Pawlowski
Marjorie Holmstrom	Mary La Farge	J. C. and Margaret McGee	Robert Payne
Lance Hoopes	Philip and Evelyn Lamb	Janeen McGinn	Ernesto and Lucia Paz
Robert and Carolyn Horn	Paul and Cynthia Lambert	Lucille McHugh	Gerry Pearson
Susan Horton	Anita Landess	Edna McKenzie	Irmgard Penner
David and Marilyn Hosea	Victor and Sylvia Landry	Katherine McLeod	David Perry
Margaret Houy	Walter and Susan Lang	Jessica McNamara	James and Joy Perry
Jack and Patricia Howard	Nola Leanna	Dale and Stella McPherson	John and Penny Pestle
Larry Howell	Fredrick and Jeannine Leary	Robert and Carol Meehan	Sarah Pestle
Kristen Howlett	Renee Lecours	Carla Meister	William Pestle
Carolyn Hubbard	Kathleen Ledesma	Anne Mendenhall	Ronald and Geraldine Peterson
Nancy Hungate	John and Mary Jo Lee	Kristi Menix	Jerrold and Mary Petzold
Barbara Hunsinger	Trevor and Jennifer Lee	Robert and Mary Metzger	Fredrick Phillips
Matthew and Cheryl Hunt	Melvyn Leffler	Barbara Milam	Randall and Rosemary Phillips
Bonnie Hyra	Lois Leichsenring	Robert and Catherine Millar	Timothy and Gail Phillips
Larry and Nancy Ice	Edward and Mary Lemire	Drea Miller	Max and Diane Pierson
Mia Igou	Michael Lemon	Michael and Carol Miller	John and Amy Pilger
Paula Imbro	Stephen Lester	Rhoda Miramontes	J. Piotrowski
Gary and Lisa Israel	Susan Lewis	Peter Molina	Richard Pitts and
Steve Jacobsen	Cathy Licinio	Warren and Martha Montgomery	Carol Hathaway-Pitts
D. Jacoby	Charlotte Lilliedahl	Jack Morrell	Kenneth and Janet Plake

Donors to Operations July 2019 - August 2020, continued

Lois Plante
Michael and Rozanne Plotnik
Jo Ann Powell
Kurt and Lynn Pritchard
Norman Pritchard
Henne Queisser
Albert and Brenda Quick
Pat Rahilly
Jan Rajeck
Hal and Marita Ramsay
Nile and Terry Ramsbottom
Roger Randrup
Robert and Janet Raphael
Stan and Sally Raskauskas
George Ratts and Linda Mendenhall
Linda Redfield
Susanne Reed
Thomas and Marilyn Regnier
Jerry and Lydia Reidelback
Mary Reynolds
David and Sue Ann Rhude
Elizabeth Richards
Carol Richardson
Ed and Ann Richardson
Kay Richardson
Loren and Norma Rickard
Louise Riley
Evelyn Ripley
Herman and Yolanda Rivera
Donald and Jerilyn Robinson
Maurine Robinson
Robb Robison
David and Linda Rodger
Richard and Austa Rogers
Cesar Romero
Elvira Romero
Sandra Rooney
Mike and Lois Rose
Alice Roy
David Roy
Gregory and Marsha Royer
Gavin Rubalcava
Sue Rudolph
Roger Rushlow and
Peggy Hendrickson
Barbara Rutkowski
Andrew Ryan
Don and Jean Saballus
Donna Sack
Elilot Sacks
Stuart and Carol Saferin
Don and Marjorie Saiser
Mark and Susan Sanders
Don Sanders
John Sandra
Robert Sargent
Ann Saunders
Patrick and Ingrid Savage
Steve Savitch
Jeff and Lynn Saylor
Arlene Schallhorn
Michael and Donna Scheer
Carrie Scheufler
Fredrick and Marion Schmidt
Joan Schneebeli
Chris Schorr
Horst and Marcia Schran
Daniel and Lavern Schroeder
Tim and Becky Schroeder

Timothy Schroer
Marlene Schulz
Katrina Schumacher
Tom Schuneman
David Schwartz
Debbie Scott
Kay Scruggs
Matthew Scully
Bruce Sergeant and
Maureen Blackford
Amanda Seybold
Steve Shapiro
Richard and Suellen Shaw
William Sheppard
Sandra Shiflet
Lynn Shinnick
Carol Shurig
Edward Sicurello
David and Linda Sielken
Lawrence and Carol Siems
Dick and Maggie Sievers
Joan Silver
Diane Simmons
Ron and Myrna Simon
Cheryl Simpson
William and Linda Simpson
Marty Sinatra
Clyde and Barbara Sincere
Roniur Singh
Russell and Cheri Sipe
Nadine Slama
Bonnie Smith
Harry and Joyce Smith
Jay and Mary Smith
Mark and Christine Smith
Richard Smith
Steve and Jackie Smith
Stuart and Beverly Smith
John Snavelly
Susan Snyder
Michael Soldwisch
Charles and Suzanne Sommerville
Albert and Barbara Southard
Daniel Spehler
Rachel Spehler
Linda Spugnardiv
Dennis and Carol St. John
Jay and June St. John
Robert Starr and Sherri Butler
Doris Steffy
Yvonne Steinbring
Theodore Steinke
William and Vickie Stephenson
Laurence and Jan Steven
Cathy Stevens
Dorothy Stewart
Stephen and Kathleen Stewart
Jay Stickle
Vera Stirsmann
John and Pat Stocker
Kathleen Stocker
Douglas Stoehr
Rosemary Stoltenberg
Charles and Margaret Stoneback
Gregg and Kathleen Stotz
Richard and Ann Stout
Karen Strand
Jerry and Wendy Strasser
Mary Anne Strauss

Ann Striker and Valerie Diamond
Jack and Mary Strosin
James and Susan Struthers
Barry Sullivan
Paul and Maurine Sutton
Stephen and Sue Svik
Alma Sychuck
Doug and Linda Syme
Bob and Liz Symington
Jennifer Symons
Nanette Taller
Tsukiyo Tanaka
Gordon and Margaret Tans
Patricia Taylor
Thomas and Joanne Taylor
Wayne and Betty Teter
Bonnie Tetzlaff
Louis and Helen Thares
Tobey Thatcher
Linda Theder
Allen and Catherine Thiele
Gary and Jo Ann Thiele
Rose Thiesen
Claudette Thomas
Elizabeth Thomas
Jennifer Thompson
Michelle Thompson
Judith Thoreson
Darthea Tilley
Chuck and Judy Tomhave
Gordon Toncheff
Janet Topolski
Mike and Linda Touzeau
Anne Towne
Arthur Treccani
Beverly Travers
James Trobec
Terry and Deanne Tubb
Kathy Tucker
Shirley Looney
Shirley Tucker
Linda Tukenmez
Dianne Turner
Bruce Ullock
Chris Ulrich
James and Cindy Uminski
William and Karen Unangst
Lorraine Underwood
Kathy Urbaniak
Manuel and Sandra Valenzuela
Donald Van Atta
David and Peggy Van Dam
Diane Van Deurzen and Lisa Otey
Laine Van Hoozen
Dick and Jenny Van Treese
Kenneth and Valeria Vanrooy
Alex and Alison Vaughn
Jennifer Veary
Katherine Vinson
David and Carol Vleck
Jo Vogel
Joseph and Sherry Vogt
Vincentius Vriens
Steven and Kathleen Walder
Kim Walsh
Joyce Walton
Mike Washburn and
Brenda Hassler
James Ward

Jamie Watkins
Mary Weaver
Pamela Weber
Judith Webster
Susan Webster
Rita Webster
Jerald and Linda Wiebe
Delores Weishaupt
Linda Weissman
Mary Ann Welch
David Wells
Lynett Westergard
Larry and Sandra Wheeler
Judith Whipple
Paul and Juanita White
Bonnie Wilcox
Judy Willette
LeeAnne Williams
Paula Williams
Amada Willingham
Maria Willmeth
Marilyn Wilson
Nancy Wilson
Thomas and Mary Wilsted
Vernon and Virginia Wing
Roberta Winston
Linda Winterland
Timothy and Bonnie Wollin
Kathleen Wood
Robert and Ellen Wood
Ken and Sue Woodward
Donna Worland
Peter Wormer and Nancy Lucas
Larry Worster and Leslie De Grassi
Alan and Connie Wray
Elizabeth Wright
Watson and Priscilla Wright
Darlene Yackel
Annette Young
Betty Youngman
Michaela Young-Mitchell
Raul Yturralde
Sandra Zaccagnino
Ruth Zebb
Julie Zeilenga
Christian Zielinski and
Carmela Volpe
Betsy Zoolkoski
David and Kathy Zweig

**Thank You To Amphenol
For Our Forklift**



Go Forky!

Business/Organization/Foundation Donors To Operations July 2019-August 2020

Albertsons Companies Foundation
(via Why Hunger)
All Service Distributors
Amphenol
Arizona Community Foundation
Arizona Farm Bureau Federation
Arizona Food Bank Network
AZ Diamondbacks Foundation
BPOE Elks Lodge 2592
Buddhist Global Relief
Camera Club Green Valley RV Resort
Cardinals Charities
Country Fair White Elephant
Crosspoint Lutheran Church
Dairy Council of Arizona
Desert Diamond Casino
Desert Hills Lutheran Church
Fiesta Sahuarita
Freeport McMoRan
Copper and Gold
Friends of the Green Valley/
Sahuarita Library
Grace Church
Greater Green Valley Community
Foundation

Green Valley AA
Green Valley News
Idania Torres Insurance
La Cañada Norte I and II
KGVY LLC
Koppers Utility & Industrial Products
Optimist Club of Green Valley/
Sahuarita
P.E.O. Sisterhood Chapter DI
Pima County
Pima Federal Credit Union
Pizza Hut
Portable Practical Educational
Preparation, Inc.
Preceptor Alpha Epsilon
Quail Creek Lady Putters
Quail Creek Men's 9 Hole Golf
Assoc. (Desert Duffers)
Queen Creek Unit Rep Committee
Rancho Resort
Rancho Sahuarita
Roadrunners RV Club
Rotary Club of Green Valley
Safeway
Sahuarita Community 4-H Club

Sahuarita Pecan Festival
Sahuarita Police Department
Sahuarita Seventh-day Adventist
Church
San Ignacio Vista
San Martin de Porres
Knights of Columbus
Shamrock Foods
Shield Bar Marketing
Sprouts Farmers Market
Starbucks
Sundt Foundation
SUSD School Food Drives
Swaim Associates
TEP Retirement
The Church of Jesus Christ of
Latter-day Saints (Southern Arizona)
The Afghan Ladies of GV RV Resort
The Good Shepherd United
Church of Christ
The Good Shepherd Men's
Fellowship
The Good Shepherd Women's
Fellowship
The Kroger Company Foundation

The Mennonite Foundation, Inc.
The Valle Verde Rotary Club
The Villages Women's Club
The Weekenders
The Women of Quail Creek
Town of Sahuarita
Trico Electric Charitable Trust
Troop 18 of Girl Scouts of
Southern Arizona
Tucson Electric Power Company
Tucson Federal Credit Union
United Community Health Centers
United Way of Tucson and
Southern Arizona
Unity In The Valley
Valley Christian Church
Walmart
Wells Fargo Foundation
Why Hunger, Inc.

*Please let us know if we inadvertently
misspelled or omitted your name .*

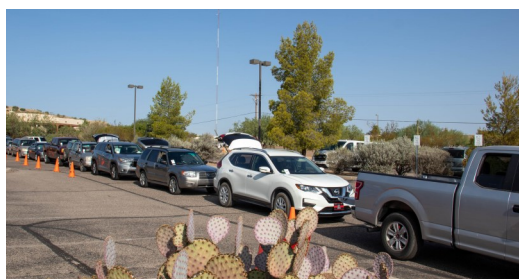

Please donate to the Sahuarita Food Bank & Community Resource Center

✓ Operations ✓ Capital

Donors may qualify for certain tax advantages:

- SFB-CRC is an independent 501(c)(3) non-profit organization.
- For federal taxpayers the CARES Act allows a deduction for cash contributions in addition to the standard deduction: \$300 individual and \$600 per couple filing jointly.
- The CARES Act also allows a federal deduction up to 100 percent of Adjusted Gross Income for qualified contributions made in 2020, rather than the standard 60 percent.
- Arizona taxpayers can claim an Arizona Qualifying Charitable Organization tax credit: \$400 per individual and \$800 per couple filing jointly. This means a donation up to those limits could cost you nothing. Donations made until April 15, 2021 qualify for the 2020 tax year. State code for Sahuarita Food Bank: 22050.

Payment information:

- Make checks payable to: Sahuarita Food Bank. (Please designate operations or capital on the memo line.)
- Send checks to: Sahuarita Food Bank, Box 968, Sahuarita, AZ 85629-0968.
- Or donate on our website: sahuaritafoodbank.org.

Your generosity makes all the difference. With your help our community will meet the challenge once again.



Do you receive our monthly email newsletter, the *Apple Basket*? If not, please sign up on our website.

2020 Sahuarita Food Bank & Community Resource Center Board of Directors

Penny Pestle, President
Curt Keim, Vice President
Jackie Smith,
Secretary-Treasurer
Nancy Ackley
Leslie DeGrassi
Nathan Hall

Irene Little-Marenin
Ann Striker
Roberta Lopez-Suter
Ex-officio, non-voting:
Randy Mayer
Carlos Valles

Photographs by
Julie Franklin
Photography



Printing Powered by:

